



# Universal Flange Adaptor

## Description

AFC Universal Flange Adaptor is made by ductile iron with EPDM / NBR gasket. EPOXY coating provided better corrosion resistance. It has wide range to fit different kinds of pipe to fit, Eg: DI, ST, PVC, AC, CI and GRP. There is always a suitable range to fit your pipe.



## Technical Spec & Material

No	Item	Material	Standard
1	Body	Ductile Iron	GJS450-10
2	End Ring	Ductile Iron	GJS450-10
3	Bolt and Nut	Carbon Steel	8.8 zinc
4	Gasket	Rubber	EPDM/NBR
5	Coating	EPOXY	WRAS Cert

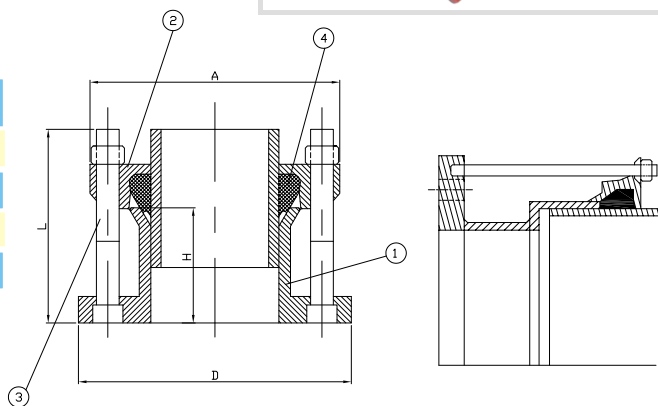

## Size Range

Pipe	Range	Pressure	Bolt		A	D	H	Weight	Pipe to fit					
Flange		Flange	L	QTY	mm	mm	mm	Kg	DI	ST	PVC	AC	CI	GRP
DN40	48-60	PN10/16	M12 X 130	2	150	150	80	2.8		★	▲			+
DN50	59-72	PN10/16	M12 X 130	2	156	165	80	3.0		★	▲	◆	○	+
DN66	72-85	PN10/16	M12 X 130	2	174	190	80	3.9		★	▲		○	+
DN80	88-103	PN10/16	M12 X 130	4	185	200	80	4.8	●	★	▲	◆	○	+
DN100	96-116	PN10/16	M12 X 130	4	205	220	80	5.0	●	★	▲	◆		
DN100	108-120	PN10/16	M12 X 130	4	210	220	80	6.3	●	★	▲			
DN100	105-125	PN10/16	M12 X 130	4	210	220	80	5.3	●	★	▲	◆	○	
DN100	109-128	PN10/16	M12 X 130	4	218	220	80	5.5	●	★		◆	○	+
DN125	132-146	PN10/16	M12 X 140	4	240	250	80	6.5		★				+
DN125	138-153	PN10/16	M12 X 140	4	246	250	80	6.6		★	▲		○	+
DN150	158-172	PN10/16	M12 X 140	4	275	285	80	7.5	●	★	▲			
DN150	155-175	PN10/16	M12 X 140	4	275	285	80	7.5	●	★	▲			
DN150	159-182	PN10/16	M12 X 140	4	280	285	80	7.6	●	★	▲	◆	○	+
DN175	192-210	PN10/16	M12 X 140	4	312	340	80	11.0		★	▲		○	
DN200	192-210	PN10/16	M12 X 140	4	312	340	80	11.2		★	▲		○	
DN200	198-225	PN10/16	M12 X 140	4	320	340	80	12.0	●	★	▲		○	+
DN200	218-235	PN10/16	M12 X 140	4	328	340	80	10.6	●	★	▲	◆	○	+
DN250	242-262	PN10/16	M12 X 140	6	360	400	85	14.0		★	▲	◆	○	
DN250	250-267	PN10/16	M12 X 140	6	368	400	85	14.5			▲	◆	○	
DN250	250-274	PN10/16	M12 X 150	6	370	400	85	14.8	●	★	▲	◆	○	+
DN250	272-289	PN10/16	M12 X 150	6	382	400	85	14.9	●	★	▲	◆	○	+
DN300	315-332	PN10/16	M12 X 150	6	430	455	85	17.9	●	★	▲			+
DN300	322-339	PN10/16	M12 X 150	6	435	455	85	17.0	●	★		◆	○	+
DN300	340-360	PN16	M12 X 170	6	455	455	85	35.0		★	▲	◆	○	
DN350	340-360	PN10/16	M14 X 190	8	455	520	115	28.0		★	▲	◆	○	
DN350	351-378	PN10/16	M14 X 170	8	510	520	108	28.0	●	★	▲	◆		+
DN350	374-391	PN10/16	M14 X 180	8	520	520	108	30.4	●			◆		
DN400	390-410	PN10/16	M14 X 150	8	530	580	108	33.5		★	▲	◆		
DN400	398-430	PN10/16	M14 X 210	8	560	580	108	34.0	●	★	▲	◆	○	+
DN400	417-437	PN10/16	M14 X 180	8	555	580	108	35.0	●			◆	○	+
DN400	425-442	PN10/16	M14 X 180	8	560	580	108	34.1	●				○	+
DN400	450-463	PN16	M14 X 180	8	585	580	108	40.0		★	▲	◆	○	
DN450	455-475	PN10/16	M14 X 180	10	600	640	108	32.0		★		◆		
DN450	476-500	PN10/16	M14 X 180	10	620	640	108	34.0	●		▲	◆	○	
DN500	500-508	PN10/16	M14 X 180	10	520	715	114	49.5		★	▲	◆	○	
DN500	500-533	PN10/16	M14 X 210	10	680	715	124	50.0	●	★	▲			+
DN500	526-546	PN10/16	M14 X 180	10	663	715	114	49.0	●			◆	○	+
DN600	600-630	PN10/16	M14 X 180	10	725	840	114	60.0		★	▲	◆	○	
DN600	608-636	PN10/16	M14 X 200	10	740	840	130	78.2	●	★	▲			+
DN600	630-650	PN10/16	M14 X 180	10	745	840	118	66.5	●		▲		○	
DN700	710-739	PN10/16	M16 X 180	12	875	910	114	72.0	●	★	▲		○	+
DN800	816-842	PN10/16	M16 X 210	12	986	1025	128	120.0				◆	○	+

\* The special mark "● / ★ / ▲ / ◆ / ○ / +" means the adaptor range is fit for different kind of pipe material